

DPC 500



The DPC 500 is resistant to rising moisture and rotproof, securely protects the masonry from the ground up. Embossed surface to assist mortar adhesion. Its high elongation at break allows an optimal bridging of settlement cracks. The DPC 500 is cold-crack-resistant and does not allow crack formation during the laying process. Moreover, it is easy and efficient to install directly from the 25 m long roll. With a weight of ca. 460 g/m², the membrane makes processing much easier. It is UV-stabilised, bitumen-resistant and allows easy and compact storage at trade partner and processor locations. The DPC 500 boasts tried-and-tested resistance to the effects of acidic, alkaline or saline groundwater, backwater or seepage water – as well as to normal chemical influences from adjacent components.

Material	LDPE
Colour	Schwarz / Graphit
Thickness	0,5 mm
Watertightness Din EN 1928 Procedure B	waterproof (400 kPa for 24 h)
Resistance to impact DIN EN 12691 Procedure A (hard support)	Drop height 300 mm
Static load DIN EN 12730 Procedure B (hard support)	No perforation at 20 kg for 24 h
Tensile resistance (DIN EN 12310-1)	
MD	200 N
CMD	190 N
Resistance	Bitumen resistant
Temperature resistance	-50 °C bis +80 °C
sd value	150 m
Roll length	25 m*
Roll width	11,5 / 17,5 / 24 / 30 / 36,5 / 50 / 75 / 100 cm*

* Further roll lengths and widths on request!

The content of this technical data sheet reflects the current state of knowledge at the time of its creation and makes no claim to be complete. The specifications listed here do not absolve the user from acting on his or her own responsibility. All previous versions of this sheet lose their validity with the publication of this sheet. Errors and typing errors reserved.

INSTALLATION INSTRUCTIONS

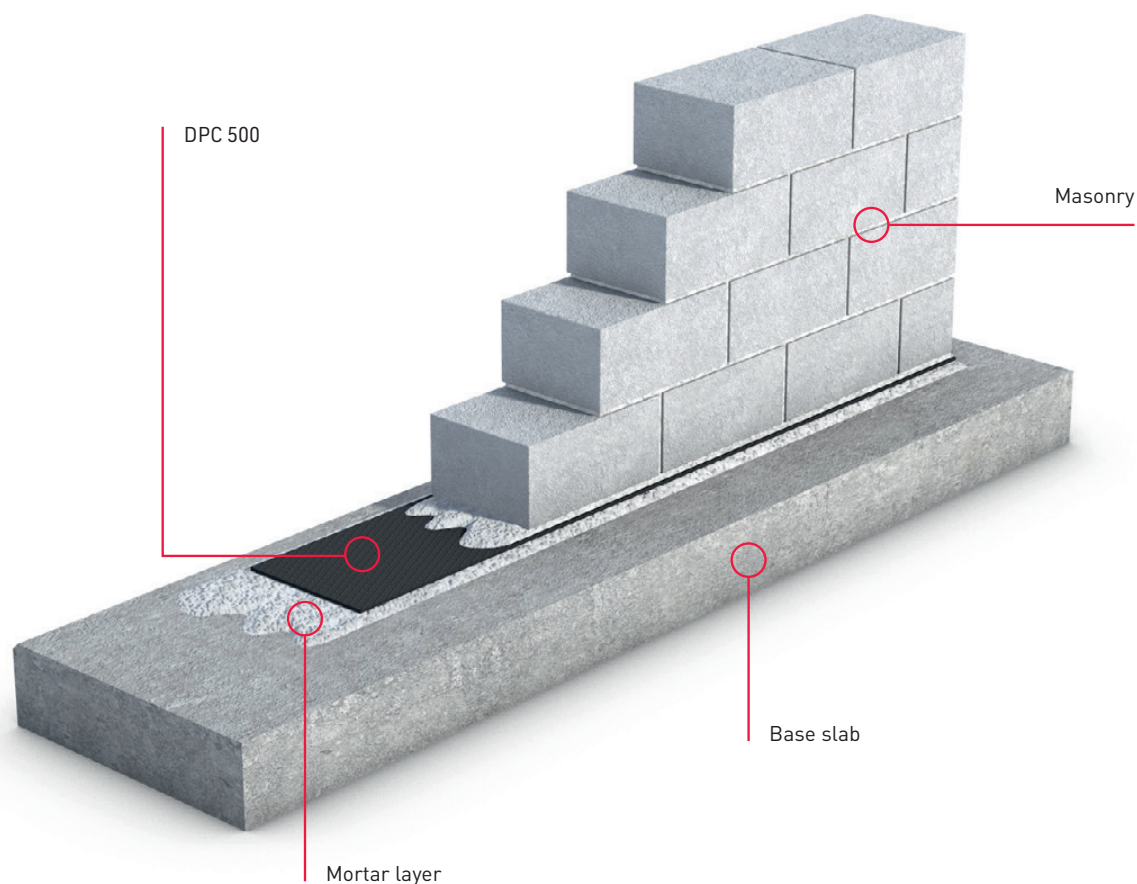

Installation instructions

The DPC 500 is laid in one layer. The surface must be levelled out using Group 2 or 3 mortar acc. to DIN 1053 in order to obtain an even surface. Then install the DPC 500 between two mortar layers under the first stone. At the joints, a sufficient overlap of 20 cm

must be ensured. The width of the damp proof course must be selected so that no moisture bridges can form to the side of the bricked-up wall.